

## Emergency Fixtures Replacement Parts

### Classic Model Parts

#### Eyewash Bowls



- **154-058**  
Impact-resistant plastic eyewash bowl, 10" diameter



- **187-053**  
Corrosion-resistant stainless steel bowl, 10 $\frac{3}{4}$ " diameter

#### Dust Caps

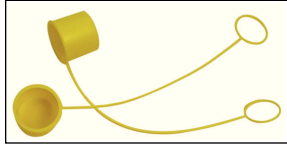

- **107-371**  
Eyewash dust caps only (sold individually; two required per eyewash). Yellow plastic tether. Approximately 1" x 1".



- **S53-063**  
Dual Eye/Face wash dust caps only (sold individually; two required per eyewash). Beaded chain tether, 2 $\frac{1}{4}$ " x 1".



- **S53-310**  
Eyewash dust cap (sold individually; two required per eyewash). Beaded chain tether, 1" x 1".

### Sprayhead and Spray Ring Assemblies

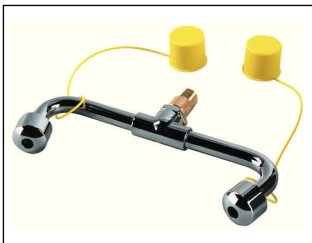

- **S39-394**  
Eyewash sprayhead assembly with supply stem

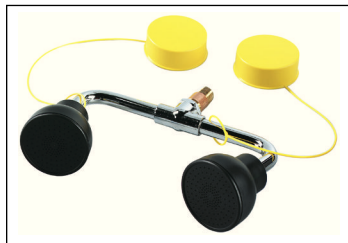

- **S39-396**  
Eye/face wash sprayhead assembly with supply stem

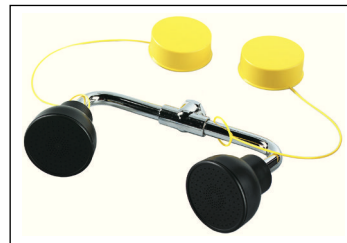

- **S39-681**  
Eye/face wash sprayhead assembly; stem not included

- **S39-682 (not shown)**  
Eye/face wash sprayhead assembly for use with PVC unit only. Stem not included



- **S45-2453**  
Eye/face wash (sprayheads only) Includes 2.4 GPM flow control inside each head. Total flow from dual heads is 4.8 gpm



- **S39-397**  
Eyewash and spray ring assembly with supply stem



- **S05-127**  
Spray ring only; requires cross-connection yoke for attachment to eyewash

[Bradley S19-220HFP12 Eyewash Station Frost Proof Wall](#)  
[Bradley S19-220HFP18 Eyewash Station Frost Proof Wall](#)  
[Bradley S19-220HFP8 Eyewash Station Frost Proof Wall Mount](#)

## Classic Model Parts

### Eyewash Ball Valves, Handles and Hardware



- S45-122**  
Plastic eyewash handle with 1/2" brass NPT stay-open ball valve and hardware
- S45-123**  
Plastic eyewash handle with hardware
- 128-135**  
Plastic eyewash handle only
- S27-282**  
Brass 1/2" NPT stay-open ball valve only



- S30-070**  
Stainless steel eyewash handle with 1/2" brass NPT stay-open ball valve and hardware
- S30-071**  
Stainless steel eyewash handle with hardware
- S08-336**  
Stainless steel eyewash handle only
- S27-282**  
Brass 1/2" NPT stay-open ball valve only



- S30-072**  
For stainless steel hinged dust covers only. Stainless steel eyewash handle with 1/2" brass NPT stay-open ball valve and hardware
- S30-087**  
For stainless steel hinged dust covers only. Stainless steel eyewash handle with hardware
- S27-282**  
Brass 1/2" NPT stay-open ball valve only



- S30-074**  
For S19-270BL (left-hand) eyewash only. Stainless steel eyewash handle with 1/2" brass NPT stay-open ball valve and hardware
- S30-075**  
For S19-270BL (left-hand) eyewash only. Stainless steel eyewash handle with hardware
- S27-282**  
Brass 1/2" NPT stay-open ball valve only



- S30-109**  
Stainless steel eyewash handle with 1/2" stainless steel NPT stay-open valve
- S30-110**  
Stainless steel eyewash handle with 1/2" vented stainless steel NPT stay-open ball valve
- S30-111**  
316 stainless steel eyewash handle without dust cover with 1/2" stainless steel NPT stay-open ball valve
- S30-116**  
316 stainless steel eyewash handle with hardware



- S30-112**  
Stainless steel eyewash handle with dust cover with 1/2" stainless steel NPT stay-open ball valve



- S08-338**  
For all-stainless steel units only. Stainless steel eyewash handle (can only be used with S27-287 ball valve)
- S08-338SS**  
For all 316 stainless steel units only. 316 stainless steel eyewash handle (can only be used with S27-287 ball valve)



- S27-287**  
Stainless steel 1/2" NPT stay-open ball valve  
**Discontinued 4/1/2013**  
S30-109 or S08-338 are available for replacement parts.

## Classic Model Parts

### Stem Assemblies, Spacers and Flow Restrictors

Sprayhead Assembly	Galvanized Fixture with Plastic Bowl	Galvanized Fixture with Stainless Steel Bowl	Standard Stainless Steel Fixture	316 Stainless Steel Fixture
Eyewash Only	S21-071 (stem) 113-1185 (stem spacer)	S21-071 (stem) 113-1159 (stem spacer)	S21-072 (stem) 113-1159 (stem spacer)	S21-075 (stem) 113-1159 (stem spacer)
Eye/Face Wash with Spray Ring	S21-073 (stem) 113-1185 (stem spacer)	S21-073 (stem) 113-1159 (stem spacer)	S21-074 (stem) 113-1159 (stem spacer)	None
Eye/Face Wash with Dual Black Heads	113-1150 (stem)	113-1150 (stem)	113-1151 (stem)	None

Spacers 113-1159 and 113-1185 are required for units that shipped on or before 11/2/2005.

### Stem Assemblies



- S21-071**  
Brass stem assembly with flow restrictor; **for units with eyewash only**
- 113-1150**  
Brass stem only; **for units with dual black eye/face wash heads**



- S21-072**  
stainless steel stem assembly with flow restrictor; **for stainless steel units with eyewash only**
- S21-075**  
316 stainless steel stem assembly with flow restrictor; **for 316 stainless steel units (with eyewash) only**
- 113-1151**  
stainless steel stem only; **for stainless steel units with dual black eye/face wash heads**

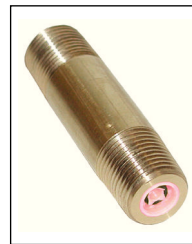

- S21-073**  
Brass stem assembly with flow restrictor; **for units with eyewash and spray ring only**



- S21-074**  
stainless steel stem assembly with flow restrictor; **for stainless steel units with eyewash and spray ring only**

### Stem Spacers



- 113-1159**  
Stainless steel stem spacer; for use in units with stainless steel bowl



- 113-1185**  
Black plastic stem spacer; for use in units with yellow plastic bowl

### Eyewash and Eye/Face Wash Flow Restrictors

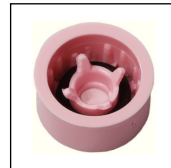

- 125-167**  
3.7 GPM pink flow restrictor; **for eyewash with face spray ring only** (stem not included)



- 125-032**  
3.5 GPM black flow restrictor; for swing-activated and swing-down units

# Emergency Fixtures Replacement Parts

## Halo Model Parts

### Covers and Bowl Kits



**187-320**  
Plastic bowl



**S90-390**  
Plastic bowl cover kit



**S90-391**  
Stainless steel bowl kit



**S90-388**  
Stainless steel bowl cover kit

**S90-392**  
316 stainless steel bowl kit

### Sprayhead Assemblies



**S05-190**  
Sprayhead assembly



**S05-192**  
Sprayhead assembly

### Dust Cover Kits



**S45-2675**  
Eyewash cover kit

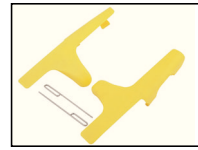

**S45-2676**  
Eye/Face wash cover kit

### Ball Valves



**S27-327**  
Chrome-plated brass 1/2" ball valve

**S27-328 (not shown)**  
Stainless steel 1/2" ball valve

### O-ring and Flow Control



**S65-339**  
O-ring and Screen



**S88-068**  
O-ring and flow control

### Handle Kit



**S08-390**  
Handle Kit

## Emergency Fixtures Replacement Parts

### Spintec™ Showerhead and Drench Shower Parts

- Includes integral 22gpm flow restrictor
- Fully distributes water throughout spray pattern
- Compact design minimizes footprint in your facility



□ **S24-192**  
Plastic shroud and ring  
(showerhead not included)



□ **S24-193**  
Stainless steel shroud and ring  
(showerhead not included)



□ **S24-194**  
Plastic showerhead and 1"  
diameter 90° elbow



□ **S24-200**  
Stainless steel showerhead and  
1" diameter 90° elbow



□ **S24-195**  
Plastic shroud with ring, plastic  
showerhead and 1" diameter 90° elbow



□ **S24-196**  
Stainless steel shroud with ring, plastic  
showerhead and 1" diameter 90° elbow



□ **S24-202**  
Plastic showerhead, white steel in-ceiling recessed shroud  
assembly, ring, coupling and 1" diameter 90° elbow



□ **154-147**  
Ring only



- **128-156A**  
Drench shower handle for standard  
(non-barrier-free) units (25½" x 9")
- **128-156B**  
Drench shower handle for flush-mount  
(non-barrier-free) units (36" x 9")
- **128-156G**  
Drench shower handle for heat trace  
units (27" x 9")

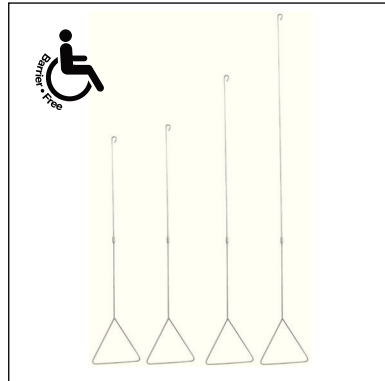

- **128-156C**  
Drench shower handle (48" x 9")
- **128-156D**  
Drench shower handle (standard; shipped  
with barrier-free showers) (45½" x 9")
- **128-156E**  
Drench shower handle (57" x 9")
- **128-156F**  
Drench shower handle (69" x 9")



□ **S30-059**  
Chrome-plated brass 1"  
NPT ball valve with lever

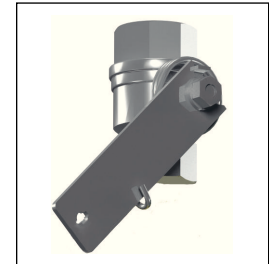

□ **S19-0011**  
Self-closing ball valve  
*NOTE: Self-closing ball valves  
are not ANSI Z358.1 compliant  
Appendix B3. However an  
exception may be made in a  
'school laboratory' situation.  
Contact local authorities  
regarding specific application*

- **S27-278**  
Chrome-plated brass 1"  
NPT ball valve only
- **S30-061 (not shown)**  
Stainless steel 1" NPT  
ball valve with lever
- **S27-276 (not shown)**  
Stainless steel 1" NPT  
ball valve only

# Emergency Fixtures Replacement Parts

## Drench Hose Parts

### Hoses



**S89-002**  
8' thermoplastic hose;  
yellow

**S89-003**  
6' stainless steel hose



**269-053**  
12' thermoplastic  
hose; yellow

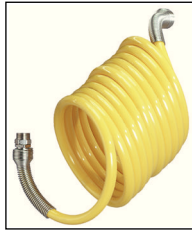

**269-054**  
25' thermoplastic  
hose; yellow

### Valve - Hose Spray

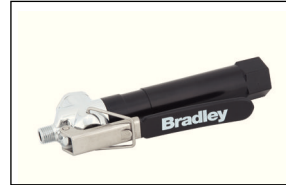

**S27-265**  
Replacement valve only

### Hose Guide Bracket

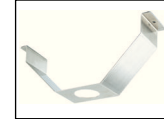

**140-226**  
Drench hose  
guide bracket

### Backflow Prevention



**S27-303**  
Dual-check  
backflow preventer  
compliant with  
ASSE 1024 &  
CSA B64.6 Watts  
Series 7



**S45-2309**  
Dual-check  
vacuum breaker  
compliant with  
CSA B64.6  
Watts Series 9



**S45-2310**  
Dual-check backflow  
preventer compliant with  
ASSE 1012 Watts Series  
9D; includes fittings for  
easy installation

### Drench Hose Replacement Part Valves



**S39-817**  
Replacement valve with  
drench hose sprayhead

## Other

### Safety Signs and Tags



**114-050**  
Drench shower sign



**114-051**  
Eyewash sign

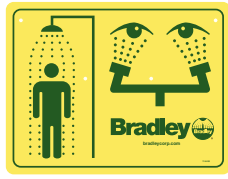

**114-052**  
Combination Drench shower and eyewash sign

### Foot Treadle Kits



**S45-572**  
Foot treadle and hardware kit (with 3-foot chain) for standard pedestal-mounted eyewashes and combination shower/eyewash units with hand operation; provides supplemental foot operation

**S45-1314SS**  
Type 316 stainless steel foot treadle and standard stainless steel hardware kit for stainless steel pedestal-mounted eyewashes and combination shower/eyewash units

**S45-1314SS16**  
Type 316 stainless steel foot treadle and 316 stainless steel hardware kit for Type 316 stainless steel pedestal-mounted eyewashes and combination shower/eyewash units

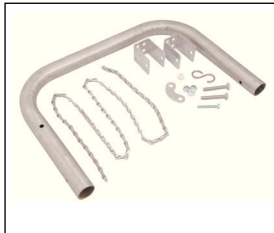

**S39-395**  
Foot treadle and hardware kit for wall-mounted eyewashes with hand operation; provides supplemental foot operation

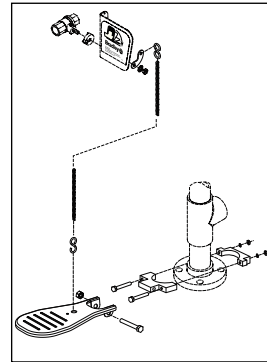

**S45-620**  
Foot treadle and hardware kit for model S19-310PVC combination drench shower and eyewash unit with hand operation; provides supplemental foot operation

### On-Site Portables



**S19-949 On-Site Eyewash Kit**  
Includes replacement cap, nine foam liners, inspection tag

**269-1379 On-Site Water Foam Liner**  
Perforated foam liner (sold individually)



**133-140**  
Gravity fed tank

### Miscellaneous Supplies

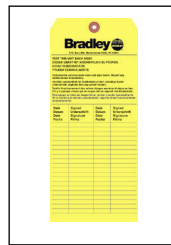

**204-421**  
Inspection Tag (sold individually)



**269-964**  
Safety yellow touch-up paint. 12-oz. aerosol

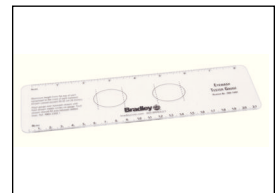

**269-1444**  
Eyewash test gauge

## Other

### Freeze and Scald Protection Kits

- **Freeze protection valves** completely open at 35°F (1.6°C) and closes at 45°F (7.2°C)
- **Scald protection valves** completely open at 105°F (40.5°C) and closes at 85°F (29.4°C)

Classic combination units require both drench shower and eyewash protection valves.



- S45-1703**  
Freeze protection replacement valve for drench showers and eyewashes
- S45-1702**  
Scald protection replacement valve for drench showers and eyewashes

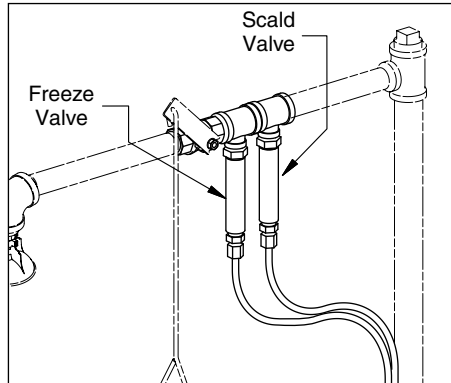

- S45-1987**  
Freeze protection kit for drench showers; includes freeze protection valve, tee, nipples, compression fitting, ball valve, tubing and cable tie
- S45-1990**  
Scald protection kit for drench showers; includes scald protection valve, tee, nipples, compression fitting, ball valve, tubing and cable tie

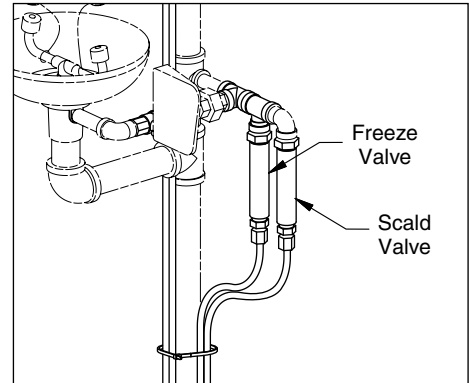

- S45-1986**  
Freeze protection kit for eyewashes; includes freeze protection valve, tee, nipples, compression fitting, ball valve, tubing and cable tie
- S45-1989**  
Scald protection kit for eyewashes includes scald protection valve, tee, nipples, compression fitting, ball valve, tubing and cable tie

### Optional Adapters

- 153-395**  
Female, 1<sup>3</sup>/<sub>16</sub>" x 24 — Chrome
- 153-396**  
Male, 3/8" NPSM — Chrome
- 153-401**  
Female, 3/4" (Garden Hose) — Chrome