

Emergency Fixtures Replacement Parts

Classic Model Parts

Eyewash Bowls



□ **154-058**
Impact-resistant plastic eyewash bowl, 10" diameter



□ **187-053**
Corrosion-resistant stainless steel bowl, 10³/₄" diameter

Dust Caps

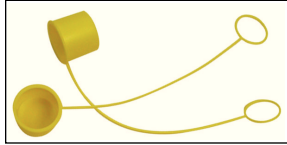

□ **107-371**
Eyewash dust caps only (sold individually; two required per eyewash). Yellow plastic tether. Approximately 1" x 1".



□ **S53-063**
Dual Eye/Face wash dust caps only (sold individually; two required per eyewash). Beaded chain tether, 2¹/₄" x 1".



□ **S53-310**
Eyewash dust cap (sold individually; two required per eyewash). Beaded chain tether, 1" x 1".

Sprayhead and Spray Ring Assemblies

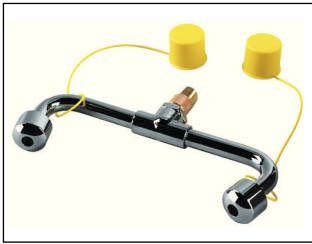

□ **S39-394**
Eyewash sprayhead assembly with supply stem

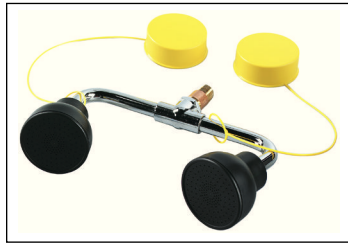

□ **S39-396**
Eye/face wash sprayhead assembly with supply stem

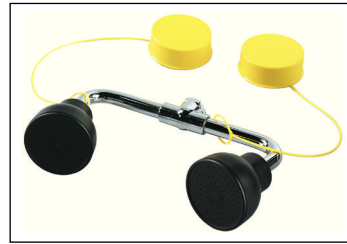

□ **S39-681**
Eye/face wash sprayhead assembly; stem not included



□ **S45-2453**
Eye/face wash (sprayheads only) Includes 2.4 GPM flow control inside each head. Total flow from dual heads is 4.8 gpm

□ **S39-682 (not shown)**
Eye/face wash sprayhead assembly for use with PVC unit only. Stem not included



□ **S39-397**
Eyewash and spray ring assembly with supply stem



□ **S05-127**
Spray ring only; requires cross-connection yoke for attachment to eyewash

[Bradley S19214B Halo Emergency Eyewash Station Bowl](#)

[Bradley S19214BSS Halo Emergency Eye Face Wash & Bowl](#)

[Bradley S19214DC Halo Emergency Eyewash Station Bowl & Cover](#)

[Bradley S19214DCFW Halo Emergency Eye Face Wash Bowl & Cover](#)

[Bradley S19214EW Halo Emergency Eyewash Station Plastic Bowl](#)

[Bradley S19214FW Halo Emergency Eye Face Wash Station Plastic Bowl](#)

[Bradley S19214P Halo Eye Face Wash Station Bowl Drench Hose](#)

[Bradley S19214PDC Halo Emergency Eyewash Station Plastic Bowl & Cover](#)

[Bradley S19214PDCFW Halo Eye Face Wash Station Plastic Bowl & Cover](#)

[Bradley S19214SS Halo Emergency Eye Face Wash Bowl](#)

[Bradley S19214Y Halo Emergency Eye Face Wash Bowl](#)

[Bradley S19214YF Halo Emergency Eye Face Wash Bowl](#)

Classic Model Parts

Eyewash Ball Valves, Handles and Hardware



- **S45-122**
Plastic eyewash handle with ½" brass NPT stay-open ball valve and hardware

- **S45-123**
Plastic eyewash handle with hardware

- **128-135**
Plastic eyewash handle only

- **S27-282**
Brass ½" NPT stay-open ball valve only



- **S30-070**
Stainless steel eyewash handle with ½" brass NPT stay-open ball valve and hardware

- **S30-071**
Stainless steel eyewash handle with hardware

- **S08-336**
Stainless steel eyewash handle only

- **S27-282**
Brass ½" NPT stay-open ball valve only



- **S30-072**
For stainless steel hinged dust covers only. Stainless steel eyewash handle with ½" brass NPT stay-open ball valve and hardware

- **S30-087**
For stainless steel hinged dust covers only. Stainless steel eyewash handle with hardware

- **S27-282**
Brass ½" NPT stay-open ball valve only



- **S30-074**
For S19-270BL (left-hand) eyewash only. Stainless steel eyewash handle with ½" brass NPT stay-open ball valve and hardware

- **S30-075**
For S19-270BL (left-hand) eyewash only. Stainless steel eyewash handle with hardware

- **S27-282**
Brass ½" NPT stay-open ball valve only



- **S30-109**
Stainless steel eyewash handle with ½" stainless steel NPT stay-open valve

- **S30-110**
Stainless steel eyewash handle with ½" vented stainless steel NPT stay-open ball valve

- **S30-111**
316 stainless steel eyewash handle without dust cover with ½" stainless steel NPT stay-open ball valve

- **S30-116**
316 stainless steel eyewash handle with hardware



- **S30-112**
Stainless steel eyewash handle with dust cover with ½" stainless steel NPT stay-open ball valve



- **S08-338**
For all-stainless steel units only. Stainless steel eyewash handle (can only be used with S27-287 ball valve)

- **S08-338SS**
For all 316 stainless steel units only. 316 stainless steel eyewash handle (can only be used with S27-287 ball valve)



- **S27-287**
Stainless steel ½" NPT stay-open ball valve
Discontinued 4/1/2013
S30-109 or S08-338 are available for replacement parts.

Classic Model Parts

Stem Assemblies, Spacers and Flow Restrictors

Sprayhead Assembly	Galvanized Fixture with Plastic Bowl	Galvanized Fixture with Stainless Steel Bowl	Standard Stainless Steel Fixture	316 Stainless Steel Fixture
Eyewash Only	S21-071 (stem) 113-1185 (stem spacer)	S21-071 (stem) 113-1159 (stem spacer)	S21-072 (stem) 113-1159 (stem spacer)	S21-075 (stem) 113-1159 (stem spacer)
Eye/Face Wash with Spray Ring	S21-073 (stem) 113-1185 (stem spacer)	S21-073 (stem) 113-1159 (stem spacer)	S21-074 (stem) 113-1159 (stem spacer)	None
Eye/Face Wash with Dual Black Heads	113-1150 (stem)	113-1150 (stem)	113-1151 (stem)	None

Spacers 113-1159 and 113-1185 are required for units that shipped on or before 11/2/2005.

Stem Assemblies



- S21-071**
Brass stem assembly with flow restrictor; **for units with eyewash only**
- 113-1150**
Brass stem only; **for units with dual black eye/face wash heads**



- S21-072**
stainless steel stem assembly with flow restrictor; **for stainless steel units with eyewash only**
- S21-075**
316 stainless steel stem assembly with flow restrictor; **for 316 stainless steel units (with eyewash) only**
- 113-1151**
stainless steel stem only; **for stainless steel units with dual black eye/face wash heads**



- S21-073**
Brass stem assembly with flow restrictor; **for units with eyewash and spray ring only**



- S21-074**
stainless steel stem assembly with flow restrictor; **for stainless steel units with eyewash and spray ring only**

Stem Spacers



- 113-1159**
Stainless steel stem spacer; for use in units with stainless steel bowl



- 113-1185**
Black plastic stem spacer; for use in units with yellow plastic bowl

Eyewash and Eye/Face Wash Flow Restrictors

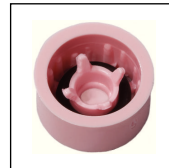

- 125-167**
3.7 GPM pink flow restrictor; **for eyewash with face spray ring only** (stem not included)



- 125-032**
3.5 GPM black flow restrictor; for swing-activated and swing-down units

Halo Model Parts

Covers and Bowl Kits



187-320
Plastic bowl



S90-390
Plastic bowl cover kit



S90-391
Stainless steel bowl kit



S90-388
Stainless steel bowl cover kit

S90-392
316 stainless steel bowl kit

Sprayhead Assemblies



S05-190
Sprayhead assembly

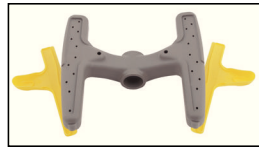

S05-192
Sprayhead assembly

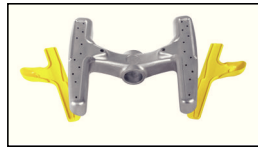

S05-204
304 Stainless steel sprayhead assembly

S05-205
316 Stainless steel sprayhead assembly

Dust Cover Kits



S45-2675
Eyewash cover kit

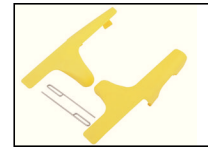

S45-2676
Eye/Face wash cover kit

Ball Valves



S27-327
Chrome-plated brass 1/2" ball valve

S27-328 (not shown)
Stainless steel 1/2" ball valve

O-ring and Flow Control



S65-339
O-ring and Screen



S88-068
O-ring and flow control

Handle Kit



S08-390
Handle Kit

Spintec™ Showerhead and Drench Shower Parts

- Includes integral 22gpm flow restrictor
- Fully distributes water throughout spray pattern
- Compact design minimizes footprint in your facility



□ **S24-192**
Plastic shroud and ring
(showerhead not included)



□ **S24-193**
Stainless steel shroud and ring
(showerhead not included)



□ **S24-194**
Plastic showerhead and 1"
diameter 90° elbow



□ **S24-200**
Stainless steel showerhead and
1" diameter 90° elbow



□ **S24-195**
Plastic shroud with ring, plastic
showerhead and 1" diameter 90° elbow



□ **S24-196**
Stainless steel shroud with ring, plastic
showerhead and 1" diameter 90° elbow



□ **S24-202**
Plastic showerhead, white steel in-ceiling recessed shroud
assembly, ring, coupling and 1" diameter 90° elbow



□ **154-147**
Ring only

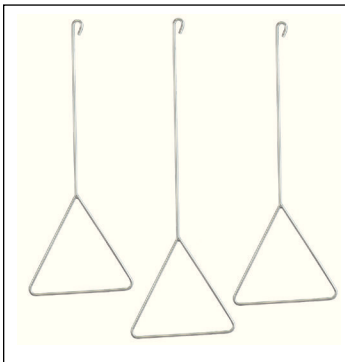

- **128-156A**
Drench shower handle for standard
(non-barrier-free) units (25½" x 9")
- **128-156B**
Drench shower handle for flush-mount
(non-barrier-free) units (36" x 9")
- **128-156G**
Drench shower handle for heat trace
units (27" x 9")

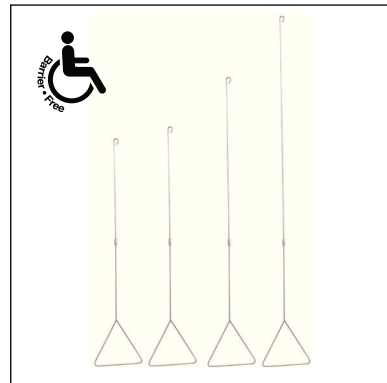

- **128-156C**
Drench shower handle (48" x 9")
- **128-156D**
Drench shower handle (standard; shipped
with barrier-free showers) (45½" x 9")
- **128-156E**
Drench shower handle (57" x 9")
- **128-156F**
Drench shower handle (69" x 9")



□ **S30-059**
Chrome-plated brass 1"
NPT ball valve with lever

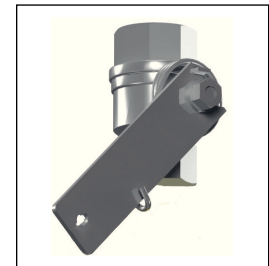

□ **S19-0011**
Self-closing ball valve
*NOTE: Self-closing ball valves
are not ANSI Z358.1 compliant
Appendix B3. However an
exception may be made in a
'school laboratory' situation.
Contact local authorities
regarding specific application*

- **S27-278**
Chrome-plated brass 1"
NPT ball valve only
- **S30-061 (not shown)**
Stainless steel 1" NPT
ball valve with lever
- **S27-276 (not shown)**
Stainless steel 1" NPT
ball valve only

Drench Hose Parts

Hoses



S89-002
8' thermoplastic hose;
yellow

S89-003
6' stainless steel hose



269-053
12' thermoplastic
hose; yellow



269-054
25' thermoplastic
hose; yellow

Valve - Hose Spray



S27-265
Replacement valve only

Hose Guide Bracket

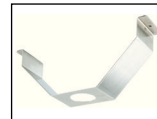

140-226
Drench hose
guide bracket

Backflow Prevention



S27-303
Dual-check
backflow preventer
compliant with
ASSE 1024 &
CSA B64.6 Watts
Series 7



S45-2309
Dual-check
vacuum breaker
compliant with
CSA B64.6
Watts Series 9



S45-2310
Dual-check backflow
preventer compliant with
ASSE 1012 Watts Series
9D; includes fittings for
easy installation

Drench Hose Replacement Part Valves



S39-817
Replacement valve with
drench hose sprayhead

Other

Safety Signs and Tags

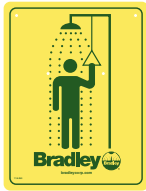

- 114-050**
Drench shower sign



- 114-051**
Eyewash sign

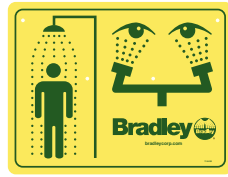

- 114-052**
Combination Drench shower and eyewash sign

Foot Treadle Kits



- S45-572**
Foot treadle and hardware kit (with 3-foot chain) for standard pedestal-mounted eyewashes and combination shower/eyewash units with hand operation; provides supplemental foot operation

- S45-1314SS**
Type 316 stainless steel foot treadle and standard stainless steel hardware kit for stainless steel pedestal-mounted eyewashes and combination shower/eyewash units

- S45-1314SS16**
Type 316 stainless steel foot treadle and 316 stainless steel hardware kit for Type 316 stainless steel pedestal-mounted eyewashes and combination shower/eyewash units

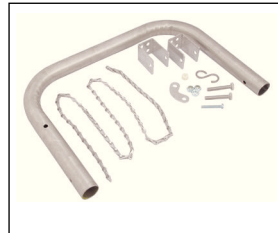

- S39-395**
Foot treadle and hardware kit for wall-mounted eyewashes with hand operation; provides supplemental foot operation

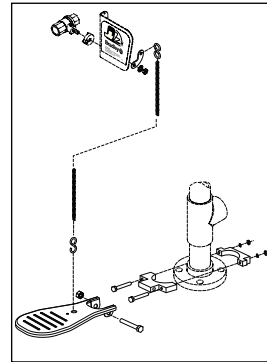

- S45-620**
Foot treadle and hardware kit for model S19-310PVC combination drench shower and eyewash unit with hand operation; provides supplemental foot operation

On-Site Portables



- S19-949 On-Site Eyewash Kit**
Includes replacement cap, nine foam liners, inspection tag

- 269-1379 On-Site Water Foam Liner**
Perforated foam liner (sold individually)



- 133-140**
Gravity fed tank

Miscellaneous Supplies

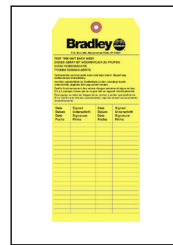

- 204-421**
Inspection Tag (sold individually)



- 269-964**
Safety yellow touch-up paint. 12-oz. aerosol

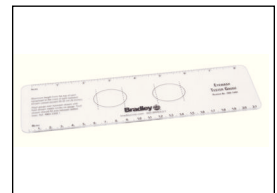

- 269-1444**
Eyewash test gauge

Other

Freeze and Scald Protection Kits

- **Freeze protection valves** completely open at 35°F (1.6°C) and closes at 45°F (7.2°C)
- **Scald protection valves** completely open at 105°F (40.5°C) and closes at 85°F (29.4°C)

Classic combination units require both drench shower and eyewash protection valves.



S45-1703

Freeze protection replacement valve for drench showers and eyewashes

S45-1702

Scald protection replacement valve for drench showers and eyewashes

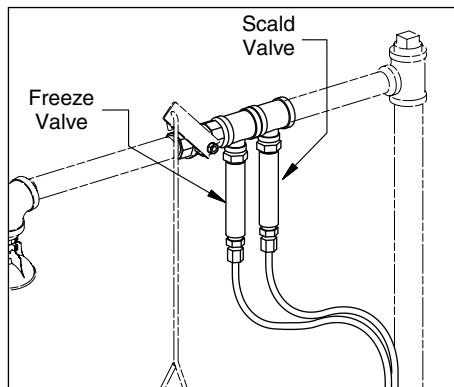

S45-1987

Freeze protection kit for drench showers; includes freeze protection valve, tee, nipples, compression fitting, ball valve, tubing and cable tie

S45-1990

Scald protection kit for drench showers; includes scald protection valve, tee, nipples, compression fitting, ball valve, tubing and cable tie

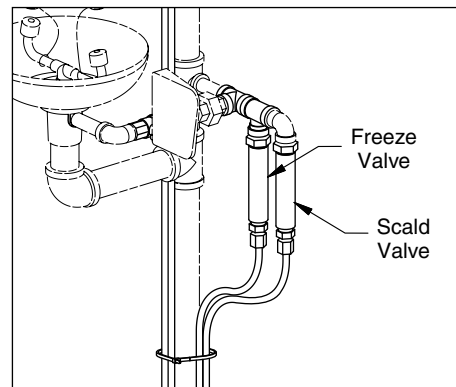

S45-1986

Freeze protection kit for eyewashes; includes freeze protection valve, tee, nipples, compression fitting, ball valve, tubing and cable tie

S45-1989

Scald protection kit for eyewashes includes scald protection valve, tee, nipples, compression fitting, ball valve, tubing and cable tie

Optional Adapters

153-395

Female, 1³/₁₆" x 24 — Chrome

153-396

Male, 3/8" NPSM — Chrome

153-401

Female, 3/4" (Garden Hose) — Chrome